

X1600 = 50
X1700 = 150
X1800 = 250

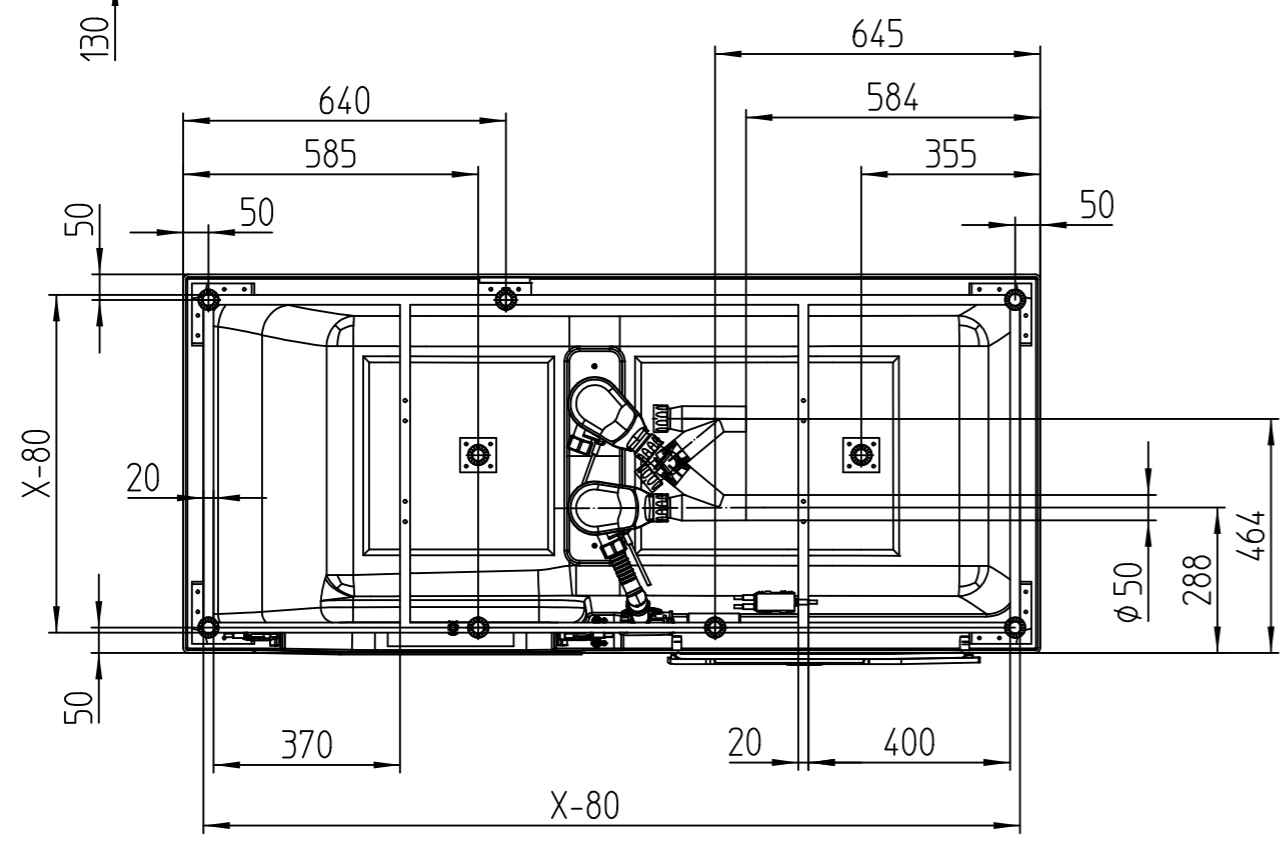

Fuss- und Ablaufpositionen
position of feet and drain

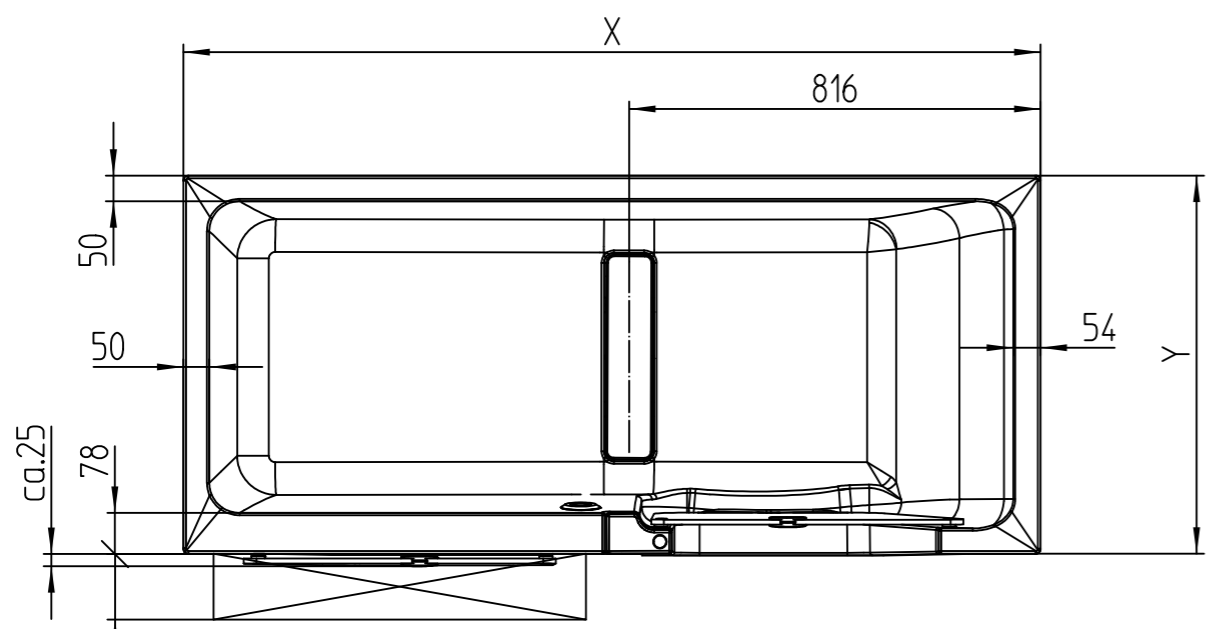
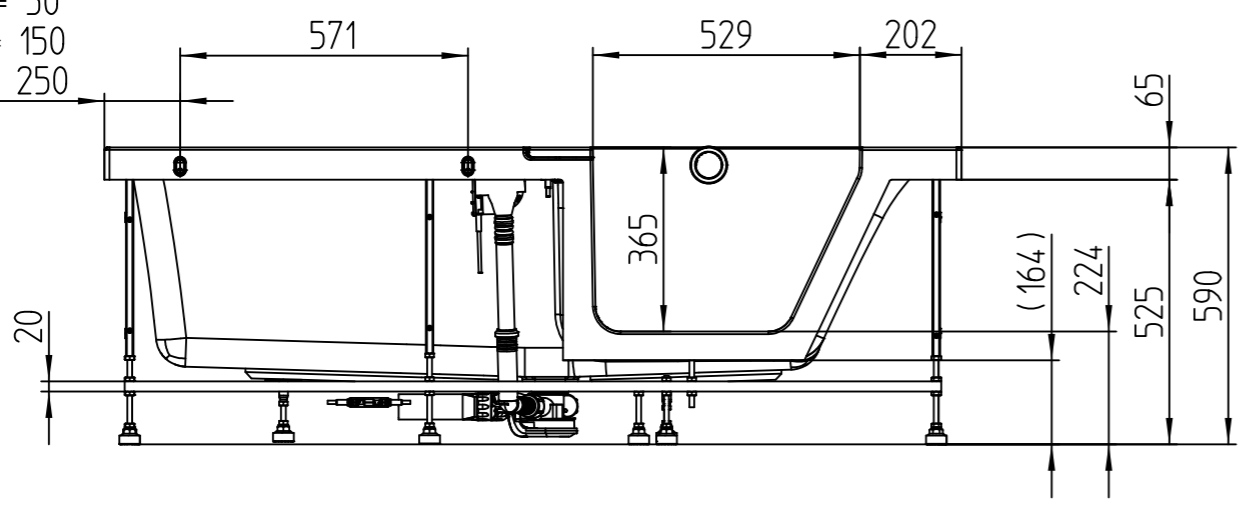
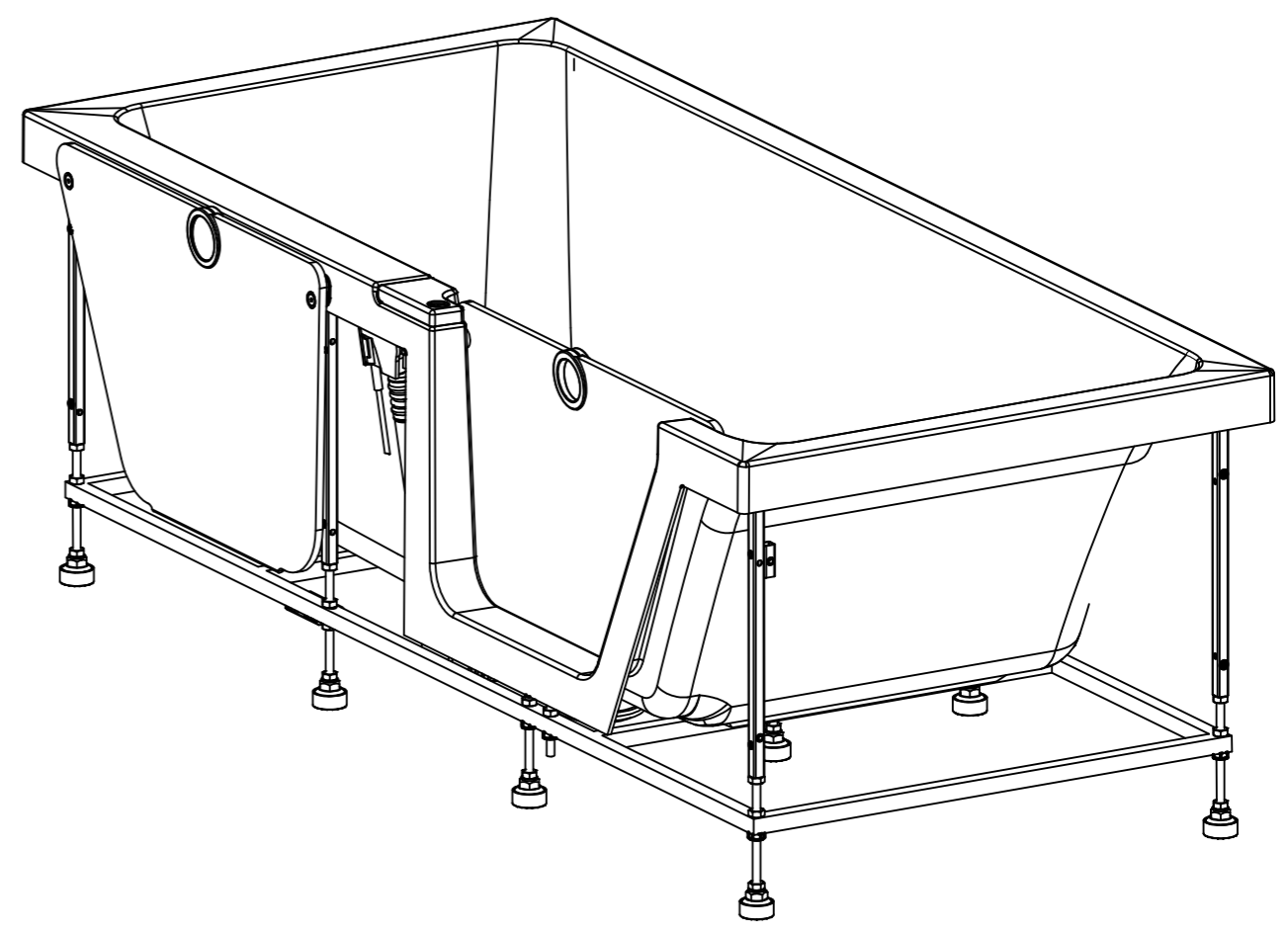

Masse können aufgrund von Fertigungstoleranzen von der Zeichnung abweichen
Because of production tolerance, measures can differ from the drawing

Typ / Type	STEP-IN PURE 1600	STEP-IN PURE 1700	STEP-IN PURE 1800
Art.Nr Ref.Nr	608.301100 608.301200	608.300100 608.300200	608.302100 608.302200
X	1600mm	1700mm	1800mm
Y	750mm	750mm	800mm
Inhalt/capacity	170l	190l	230l
Gewicht/weight	38kg	40kg	45kg